

INDUSTRY FIRST LUXURY LIGHTWEIGHT

# PREMIER

— ULTRA LITE BY BULLET —



**DSI**  
Annual RVDA DEALER  
SATISFACTION INDEX  
AWARD WINNER  
5 years IN A ROW

[www.keystonerv.com/Premier](http://www.keystonerv.com/Premier)



[www.keystonerv.com/premier](http://www.keystonerv.com/premier)

# PREMIER

ULTRA LITE BY BULLET



***EASY TO TOW WITH THE NEW MORE FUEL EFFICIENT CROSSOVERS, CARS AND TRUCKS, THE PREMIER ULTRA LITE TRAVEL TRAILER HERALDS IN A NEW GENERATION OF RVs.***

*Sleek and smooth on the outside and loaded with features and conveniences inside, the new Premier Ultra Lite will set you free to explore the open road.*



PREMIER 30R1PR KITCHEN



**PREMIER 30RIPR SHOWN IN SADDLE DECOR**



**PREMIER 30RIPR LIVING AREA**



**PREMIER 29RKPR OUTDOOR KITCHEN**



**PREMIER 30RIPR OUTDOOR KITCHEN**

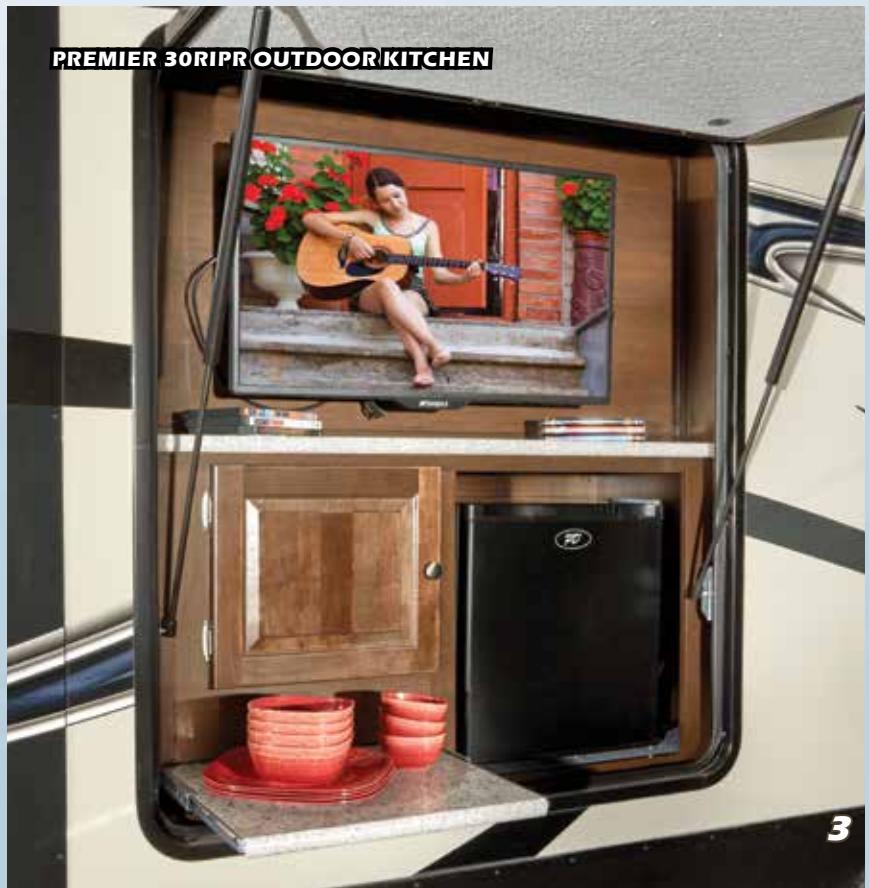

PREMIER 29RKPR SHOWN IN CHARCOAL DECOR

THE INDUSTRY'S  
FIRST LUXURY ULTRA  
LITE NOW HAS  
DEEPER SLIDES AND  
MORE FEATURES!

← 3 FEET WIDE! →

REVERSIBLE  
DINETTE CUSHIONS



PREMIER 29RKPR KITCHEN



**CONVENIENCE,  
COMFORT & STYLE**

**LAUNDRY CHUTE IN EVERY  
PREMIER FLOOR PLAN**



**PREMIER BEDROOM SHOWN IN CHARCOAL DECOR**



**PREMIER 29RKPR LIVING ROOM SHOWN IN CHARCOAL DECOR 5**



**ELECTRIC ADJUSTABLE AWNING WITH LED LIGHTING**



**STOR-MOR DINETTE DRAWERS ON STEEL BALL BEARING DRAWER GUIDES**



**MULLION DOORS**



**LARGEST PASS-THRU STORAGE IN ITS CLASS**



**LAUNDRY CHUTE IN THE MASTER BEDROOM**



**FRAMELESS TINTED WINDOWS**



**PROGRESSIVE INTERIOR LIGHTING IN MASTER BEDROOM**



**TRI-FOLD SOFA**



**MAX DEPTH SLIDEOUT ROOM IS 36" DEEP**

## COMPARE PREMIER'S DINETTE TO THE COMPETITION



**LARGE RADIUS DINETTE (N/A 19FB & 22RB)**

### PREMIER

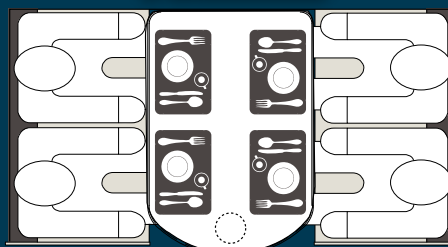

**COMFORTABLY SEATS 4 ADULTS**

- PLENTY OF ROOM FOR 4 PLACEMATS
- ONLY NEEDS ONE TABLE SUPPORT
- CONVERTS TO 80" BED

### COMPETITION

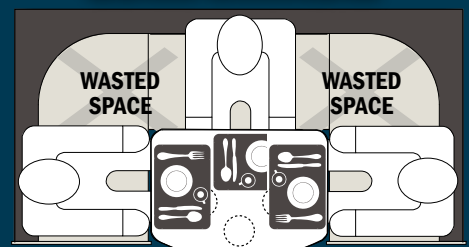

**DON'T BE FOOLED! ONLY SEATS 3 ADULTS**

- ONLY ENOUGH ROOM FOR 2.5 PLACEMATS
- 3 PEDESTAL SUPPORTS REDUCE LEG ROOM
- ALSO CONVERTS TO 80" BED



**8 CU. FT. REFRIGERATOR**



**RETRACTABLE KITCHEN FAUCET**



**OUTSIDE KITCHEN (31BHPR, 34BHPR)**



**CD/DVD/AM/FM/MP3 BLUETOOTH STEREO**



**SLAM LATCH PASS THRU STORAGE DOORS**



**STORAGE UNDERNEATH THE 60"x80" QUEEN BED**



**ROLLED ROOF EDGE PROMOTES INCREASED WATER RUNOFF**



**LED PUCK CEILING LIGHTS**



**RAISED PANEL CABINETRY THROUGHOUT**



Premier is the only ultra lite travel trailer to offer the following climate control features in all floorplans:

<b>PREMIER</b>	<b>COMPETITION</b>
Enclosed underbelly	Exposed Tanks
2" pipe off of furnace with forced air into underbelly and radiant heat	Radiant Heat Only
30,000 BTU Furnace	20,000 - 25,000 BTU Furnace
Ducted Heat and A/C	Non Ducted Heat and A/C

**LUXURY FEATURES** that matter most in Ultra-Lites.

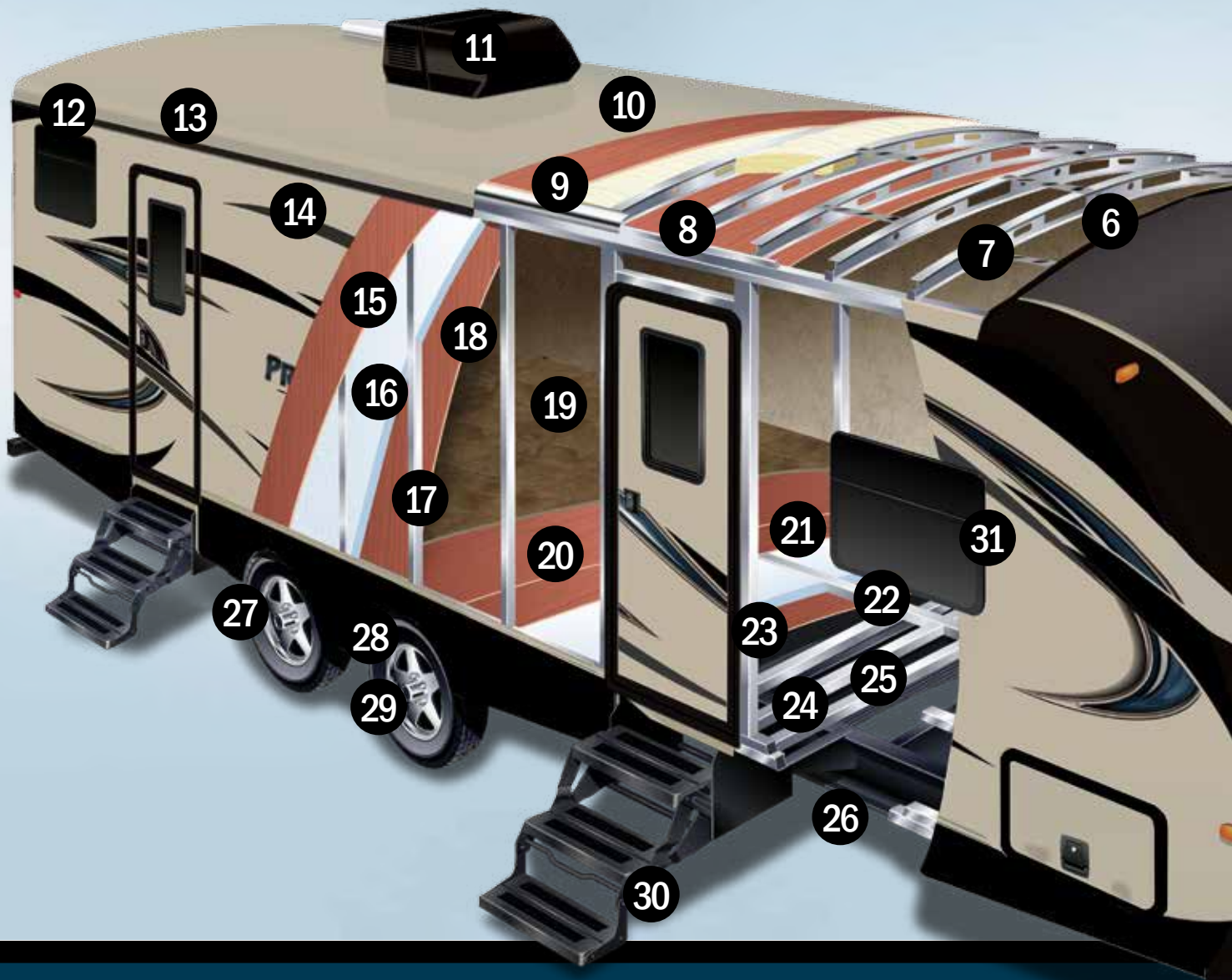

## ***BENEFITS OF A MOLDED PAINTED FIBERGLASS FRONT CAP***



### **PREMIER vs.**



*3/4" Thick molded painted fiberglass won't cold crack and is strong enough to hold up to rock damage unlike competitors ABS panels.*



*A true "Cap" is molded over the edges of the sidewall/roof and "Caps" the front end of the trailer preventing any water leaks. Many competitors "caps" are flat ABS panels that have 90 degree seams where it meets the sidewall and also a seam between the panel and rock guard which invites water intrusion.*

### **COMPETITION**





# PREMIER

— ULTRA LITE BY BULLET —

## LIGHTWEIGHT SOLID CONSTRUCTION

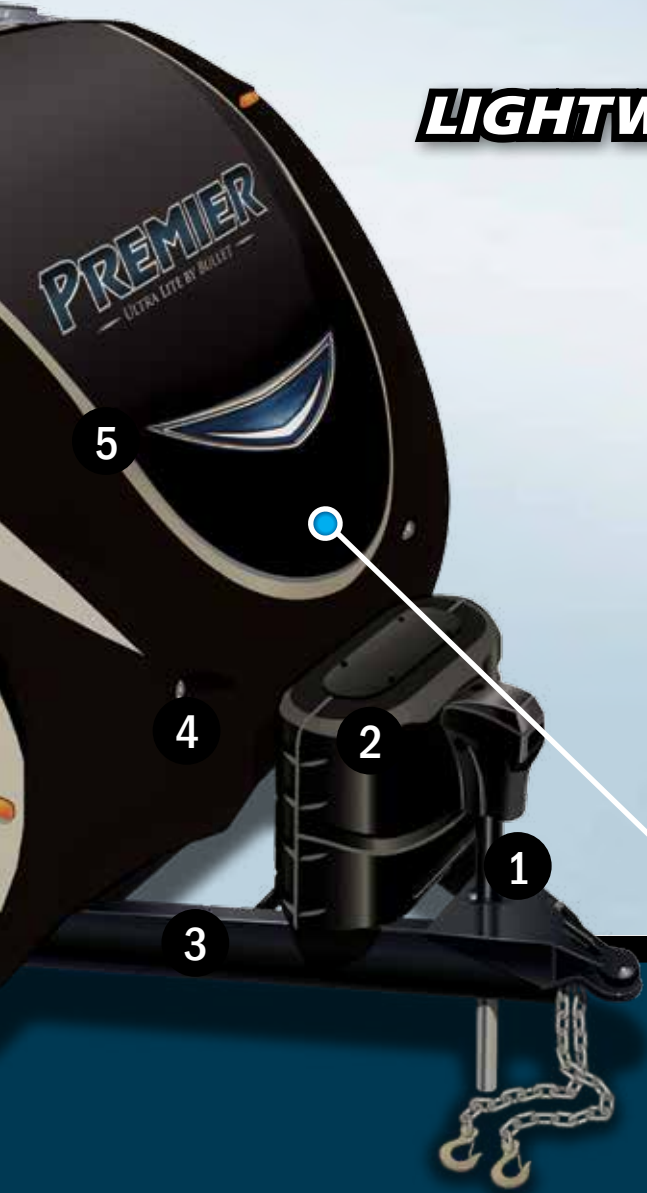

- 1. Power Tongue Jack
- 2. Quick Access LP Cover
- 3. Integrated Dual Battery Tray
- 4. LED Docking Lights
- 5. Dual Radius Fiberglass Front Cap
- 6. 5" Radius Galvanized Stamped Steel Roof Trusses
- 7. Hurricane Straps
- 8. Fully Insulated Roof
- 9. Durable Roof Decking
- 10. One Piece TPO Roof
- 11. 13,500 BTU Quick Cool Air Conditioning (optional 2nd 15,000 BTU A/C)
- 12. Full Length Rain Gutter and 4" Drip Spouts
- 13. Rolled Roof Edge
- 14. Smooth Fiberglass Exterior
- 15. 1/8" Luan Wall Backing
- 16. Hi-Density Block Foam Insulation
- 17. 1 1/2" Box Double Welded Aluminum Frame Structure
- 18. Decorative Interior Wall Board
- 19. Residential Stain Resistant Trek Linoleum (resistant to cold cracking)
- 20. Plyvener Floor Decking (water resistant)
- 21. Hi-Density In Floor Block Foam Insulation
- 22. Double Welded Aluminum Floor Joists
- 23. 3rd Layer Floor Decking
- 24. 6.5" - 10" Steel I-Beam Frame
- 25. Darco Vapor Barrier Wrap
- 26. Enclosed Heated Underbelly
- 27. Radial Tires with Electric Brakes (4)
- 28. 43" Wide Stance Axles
- 29. Easy Lube Axles
- 30. Triple Entry Radius Entry Steps
- 31. Frameless Jalousie Tinted Windows



*Keystone's multi-coat paint facility applies three layers of base coat followed by two layers of automotive clear coat. This results in a deeper color & shinier finish than the competitors dyed fiberglass or ABS caps.*

## BEST TOWING TRAVEL TRAILER IN THE INDUSTRY

Increased MPG and Easier to tow



The rear departure angle increases efficiency of windflow underneath and behind the trailer.



The enclosed underbelly eliminates turbulence caused by exposed frame members, holding tanks, plumbing etc.



Radius shape vertically and also side to side for superior aerodynamics



43" wide stance axle greatly reduces sway and bouncing



[www.keystonerv.com/premier](http://www.keystonerv.com/premier)

# PREMIER

— ULTRA LITE BY BULLET —

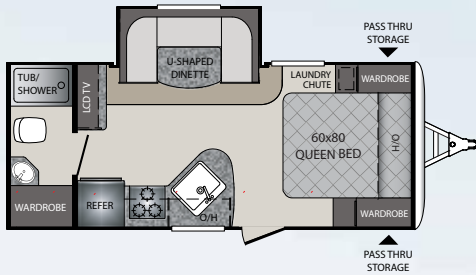

**19RBPR**

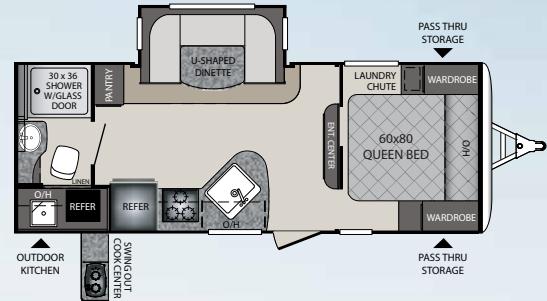

**22RBPR**

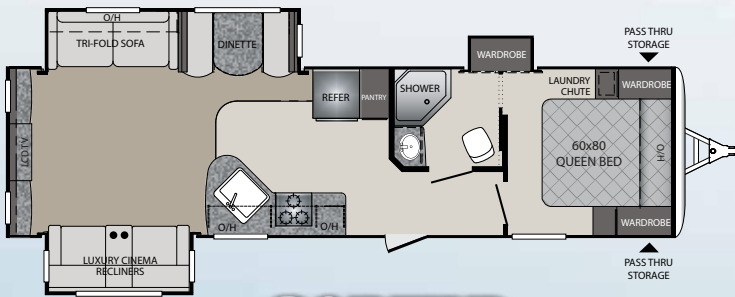

**30REPR**

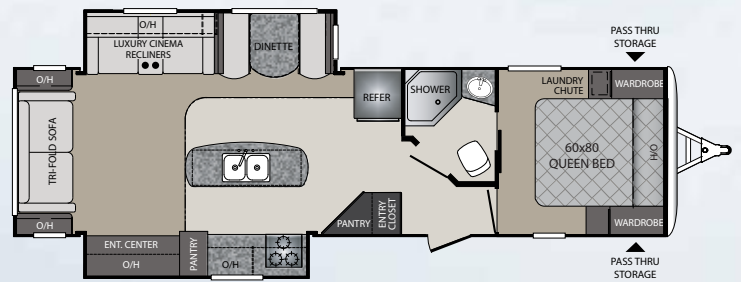

**30RIPR**

*Stay in Touch*



Premier is always just a touch away. You'll find 360 virtual tours, location of your nearest dealer, photos, videos and all of the latest information about Premier on our easy to navigate website. Everything you need can be accessed anytime, day or night, from home or on the road. You can also find us on the Keystone RV facebook.

[www.keystonerv.com/premier](http://www.keystonerv.com/premier)

# TRAVEL TRAILER FLOORPLANS

You'll find a Premier floorplan to fit your lifestyle perfectly.

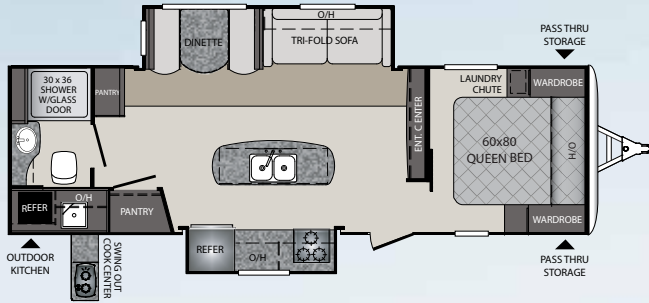

**26RBPR**

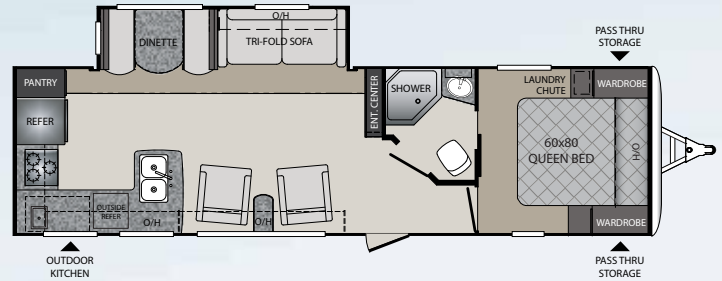

**29RKPR NEW**

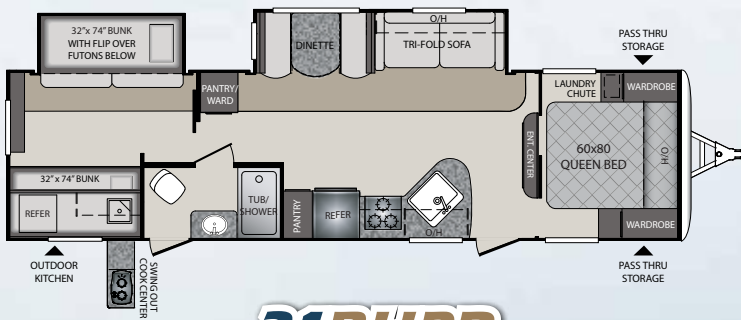

**31BHPR**

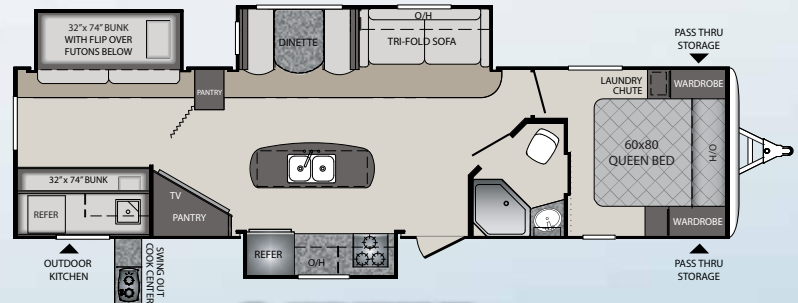

**34BHPR**

## WEIGHTS & MEASUREMENTS

MODEL	SHIPPING WEIGHT	CARRYING CAPACITY	HITCH	LENGTH*	HEIGHT	FRESH WATER	WASTE WATER	GRAY WATER	LPG	AWNING
19FBPR	4782	1718	570	23' 8"	10' 11"	43	30	30	40	14'
22RBPR	4885	1675	540	26' 4"	10' 11"	43	30	30	40	15'
26RBPR	5995	1505	715	31' 5"	10' 11"	43	30	60	40	20'
29RKPR	6145	1484	690	33' 10"	10' 11"	43	30	60	40	15'
30REPR	6760	1240	730	34' 11"	10' 11"	43	30	30	40	14'
30RIPR	6667	1533	790	35' 4"	10' 11"	43	30	60	40	20'
31BHPR	6750	1250	820	35' 8"	10' 11"	43	30	30	40	15'
34BHPR	7075	1725	805	37' 6"	11'	43	30	60	40	19'

Product information is as accurate as possible at the date of publication of this brochure. Features, floor plans, and specifications are subject to change without notice. Please also consult Keystone's web site at [keystoneRV.com](http://keystoneRV.com) for more current product information and specifications. Tow Vehicle Disclaimer. CAUTION: Owners of Keystone recreational vehicles are solely responsible for the selection and proper use of tow vehicles. All customers should consult with a motor vehicle manufacturer or their dealer concerning the purchase and use of suitable tow vehicles for Keystone products. Keystone disclaims any liability or damages suffered as a result of the selection, operation, use or misuse of a tow vehicle. KEYSTONE'S LIMITED WARRANTY DOES NOT COVER DAMAGE TO THE RECREATIONAL VEHICLE OR THE TOW VEHICLE AS A RESULT OF THE SELECTION, OPERATION, USE OR MISUSE OF THE TOW VEHICLE. \*Length is defined as the distance from the centerline of the hitch pin/coupler to rear bumper of the trailer.

# STANDARDS & OPTIONS

## CONSTRUCTION STANDARDS

- Aggressive Front Profile for Increased Towability
- Aluminum Framed Front, Rear, and Side Walls
- Aluminum Framed Slideouts
- Laminated Fiberglass Exterior Side Walls
- 2" Thick Laminated Aluminum Floor
- In Frame Fresh, Grey, and Black Water Tanks
- 6.5" - 10" Steel I-Beam with Full-Length Welded Outrigger
- ¼" ABS Enclosed Underbelly
- Darco Moisture Barrier
- One Piece TPO Roof
- E-Z Lube Axles
- Electric Brake System (4 wheels)
- R-11 Insulation in Floor
- R-7 Insulation in Sidewalls
- R-11 Insulation in Roof

## EXTERIOR CAMPING PACKAGE

- Wide Stance E-Z Lube Axles
- 6 Gallon Gas/Electric DSI Water Heater with Quick Recovery
- Radius Entry Door with Gas Strut
- Outside Speakers
- Outside Shower (Hot and Cold Water)
- 4 Stabilizer Jacks
- TV Antenna and Cable/Satellite Hook-Up
- Electric Awning with LED Lights
- Radial Tires
- Black Tank Flush

## EXTERIOR FEATURES

- Outdoor Kitchen with Galvanized Countertop (22RBPR, 29RKPR, 30RIPR, 31BHPR, 34BHPR)
- Aluminum Wheels
- Dual Propane Tanks with Cover
- In Frame Dual Battery Rack
- Oversized Exterior Pass Thru Storage with Lighting
- LP Quick Connect
- Spare Tire
- Oversized Grab Handle (main door)
- 9" Triple Entry Steps
- Slam Baggage Doors w/ Magnetic Catch

## INTERIOR CAMPING PACKAGE

- 13.5 BTU Ducted A/C
- Night Shades
- CD/DVD/AM/FM Bluetooth Stereo with Aux and I-Pod Hookup
- 32" LED TV (19FBPR, 22RBPR, 29RKPR, 30REPR, 31BHPR)
- 42" LED TV (26RBPR, 30RIPR, 34BH)
- Microwave
- 8 cu./ft. Double Door Refrigerator
- 3 Burner High Output Range
- Retractable Faucet
- All Raised Panel Hardwood Cabinet Doors
- Foot Flush Toilet
- Tub Surround with Shelves
- Full Extension Drawer Glides
- Tri-Fold Sofa (N/A 19FBPR, 22RBPR)
- Stainless Steel Sink

## INTERIOR FEATURES

- 6' 11" Vaulted Ceiling
- Flexible Fiberglass Reinforced Flooring
- Upgraded Residential Furniture
- Night Shades in Living Area
- 17" Oven
- Back Splash (residential)
- Stor-mor Dinette
- Retractable Kitchen Faucet

## BATHROOM

- Oversized Showers w/GlassDoor (N/A on 19FBPR, 31BHPR)
- Power Vent Fan
- Solid Wood Medicine Cabinet
- Linen Storage

## MASTER BEDROOM

- Upgraded Foam Mattress
- Mirrored Wardrobes
- Laundry Chute
- Under Bed Storage
- Individual Reading Lights
- Accent Wallboard

## SAFETY EQUIPMENT

- Carbon Monoxide Detector
- Smoke Alarm
- Fire Extinguisher
- Electric Brakes
- Safety Chains
- Frameless Tinted Safety Glass Windows, Egress Windows (Fire Escape)
- GFI Receipts

## OPTIONS

- Bumper Mounted Aussie Grill
- 15K A/C
- 50 AMP Service w/second A/C (N/A 19FBPR, 22RBPR)

## THERMAL PACKAGE

- Ducted Heat and Enclosed Heated Underbelly
- 2" Pipe off of Furnace to Underbelly
- 30K BTU Furnace and Residential Heat Ducts
- Radiant Heat



## PREMIER PACKAGE

- Aerodynamic Fiberglass Front Cap
- Vaulted Ceiling System
- Frameless Tinted Windows
- Power Tongue Jack
- Tri-Fold Sofa
- Max Depth Slides
- LED Flush Mounted Puck Lighting
- Upgraded Exterior Graphics Package
- Black Tank Flush

### SADDLE

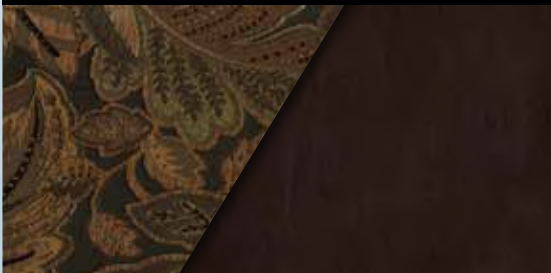

### CHARCOAL



YOUR LOCAL DEALER:

LEARN MORE



[www.keystonerv.com/Premier](http://www.keystonerv.com/Premier)

# PREMIER

— ULTRA LITE BY BULLET —

 **Keystone RV Company**  
www.keystonerv.com

2642 Hackberry Drive | PO Box 2000  
Goshen, IN 46527-2000  
(574) 535-2100

NOVEMBER 2015